

INSTALLATION INSTRUCTIONS

C550 **P3 PULSE™ Display Kit**

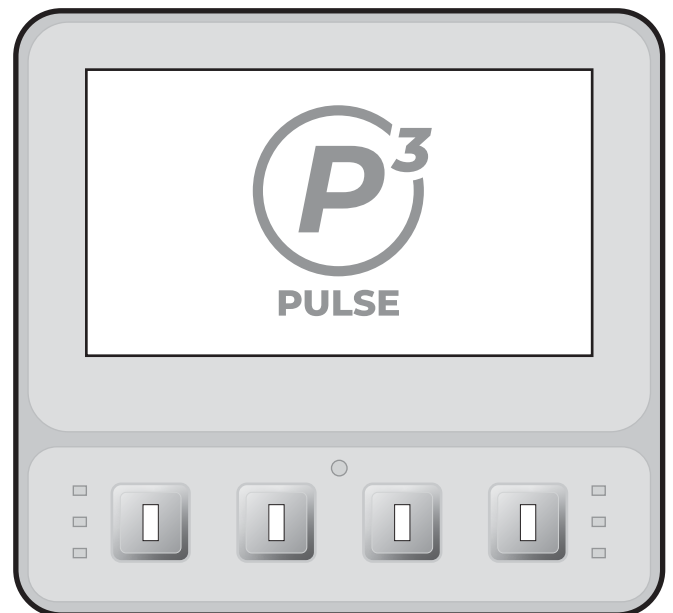

1. Introduction



WARNING!

Read the machine operator's manual before you install or use this accessory. Carefully read all the safety information and understand all the safety signs that are on the machine. Failure to read and understand the machine information can result in serious personal injury or machine damage.

The P3 Pulse display accessory only works with P3 Pulse controllers and wire harnesses that are version 3.0 and above.

Illustrations are provided for reference only. Some details may not be shown.

For support or service, contact your local Wallenstein Equipment dealer or distributor.

Wallenstein Equipment Inc. • © 2023. All rights reserved.

No part of this work may be copied, reproduced, replaced, distributed, published, displayed, modified, or transferred in any form or by any means except with the prior permission of Wallenstein Equipment Inc.

2. Safety

2.1 Safety Alert Symbol

This Safety Alert Symbol means:

ATTENTION! BE ALERT!

YOUR SAFETY IS INVOLVED!

The **Safety Alert Symbol** identifies important safety messages on the machine and in this instruction. This symbol means be alert to the possibility of personal injury or death. Follow instructions provided.



2.2 Signal Words

The signal words **DANGER**, **WARNING** and **CAUTION** determine the seriousness level of the warning messages in this manual. The appropriate signal word for each message in this manual has been selected using the following guidelines:

DANGER –

Indicates an imminently hazardous situation that, if not avoided, **will** result in death or serious injury. This signal word is to be limited to the most extreme situations typically for machine components which, for functional purposes, cannot be guarded.

WARNING –

Indicates a potentially hazardous situation that, if not avoided, **could** result in death or serious injury, and includes hazards that are exposed when guards are removed. It may also be used to alert against unsafe practices.

CAUTION –

Indicates a potentially hazardous situation that, if not avoided, **may** result in minor or moderate injury. It may also be used to alert against unsafe practices.

IMPORTANT – To avoid confusing equipment protection with personal safety messages, a signal word **IMPORTANT** indicates a situation that if not avoided, could result in damage to the machine.



Provides additional information that is helpful.

3. Accessory Components

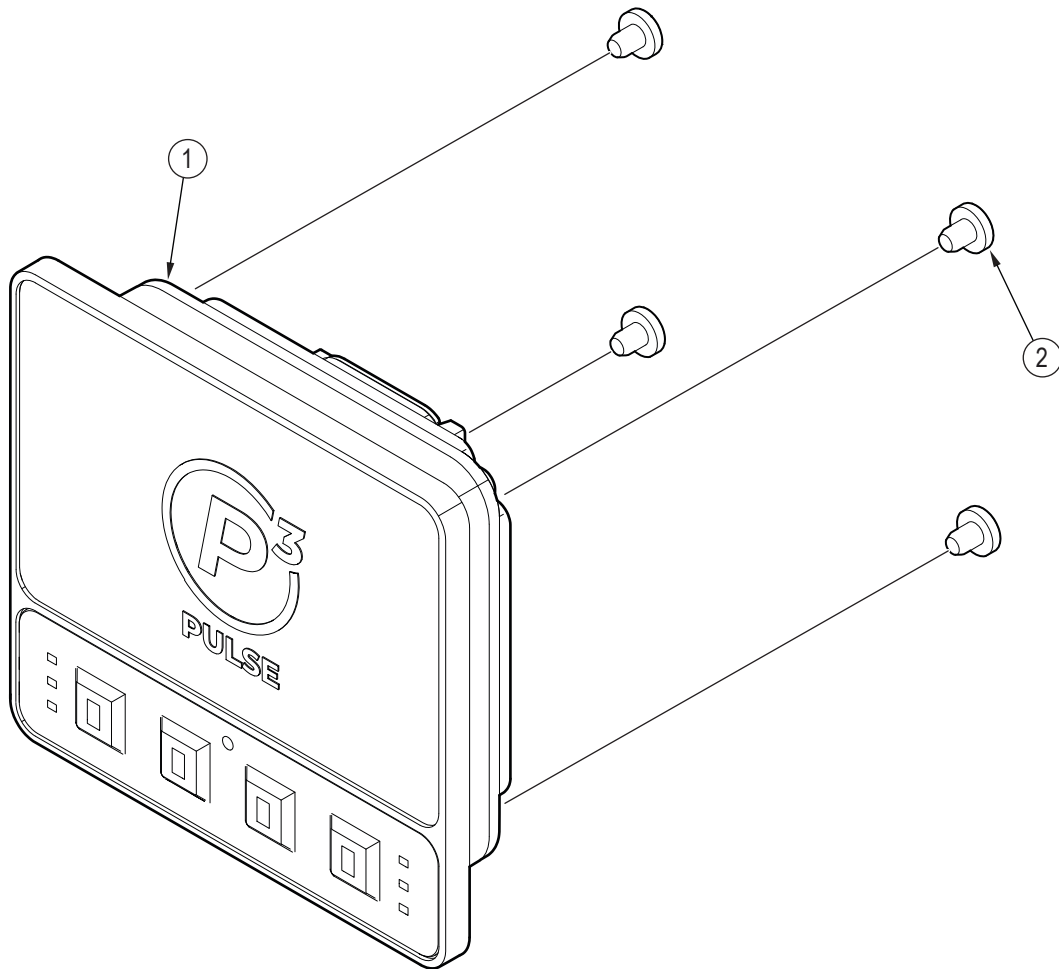

Figure 1 – C550 accessory kit components

Item	Part Number	Description	Quantity
1	1062E004	P3 Pulse display	1
2	Z77817	Screw, M4x 0.7 x 5 mm	4

4. Install a P3 Pulse Display

WARNING!

Read and follow all the installation and setup instructions. Do not modify this equipment and make sure that the equipment is installed correctly. Incorrect installation or modification of the equipment can cause serious injury or damage the machine.

4.1 Install a P3 Pulse Display on a BX52RI, BX72RI, or BX102RI Wood Chipper

The following images show the BX52RI model; however, the process is the same for all three models.

The accessory components item numbers are in brackets and defined on *page 4*.

Step 1

The P3 Pulse indicator panel is on the left side of the machine.

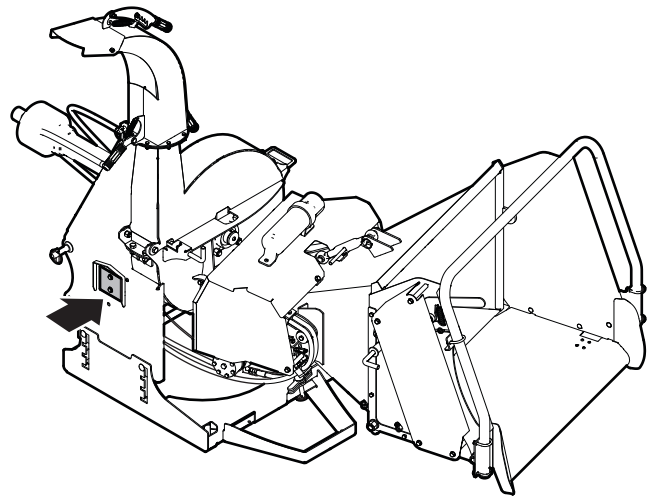

Step 2

On the rear of the indicator panel, disconnect the wire harness from the indicator panel.

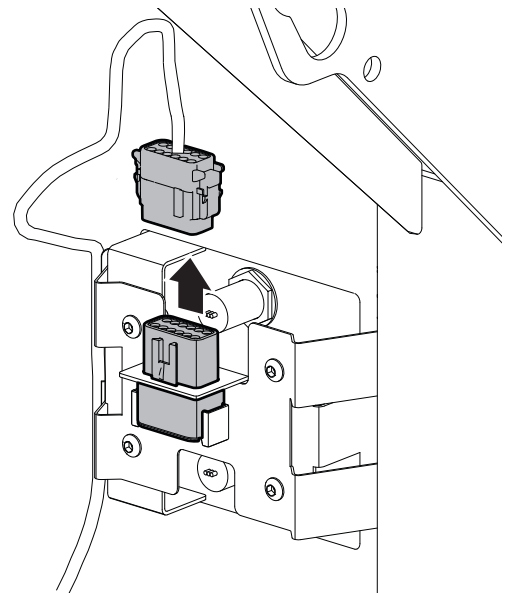

Step 3

Remove the four screws from the mounting bracket.
Set aside the fasteners. They are not necessary for installation.

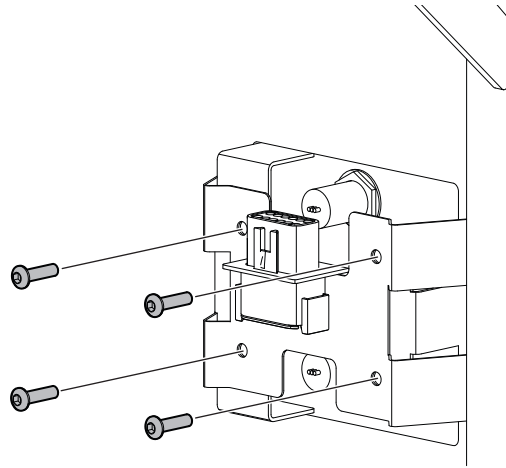
**Step 4**

Remove the mounting bracket.
Set aside the mounting bracket. It is necessary for installation.

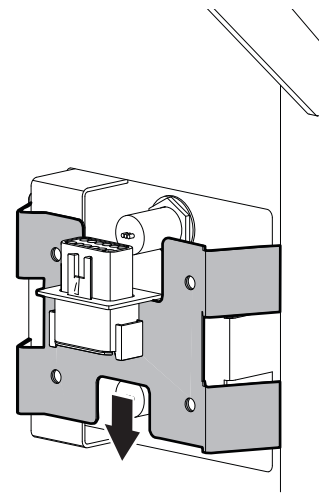
**Step 5**

Remove the indicator panel from the machine.

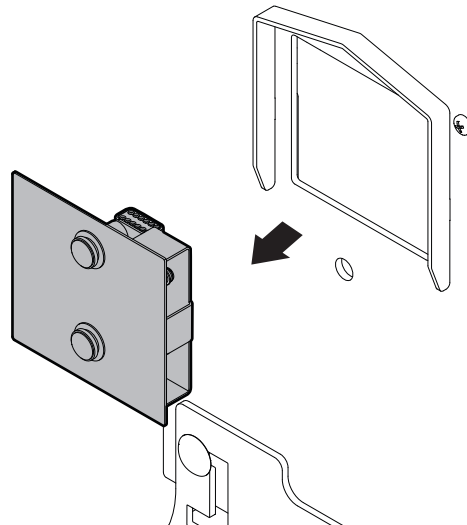

Step 6

Put the P3 Pulse display (1) in the indicator panel location.

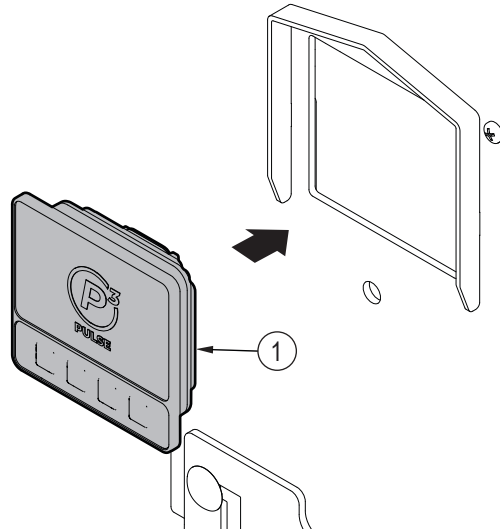

Step 7

Install the mounting bracket on the rear of the display (1).
Align the four mounting bracket holes with the display.

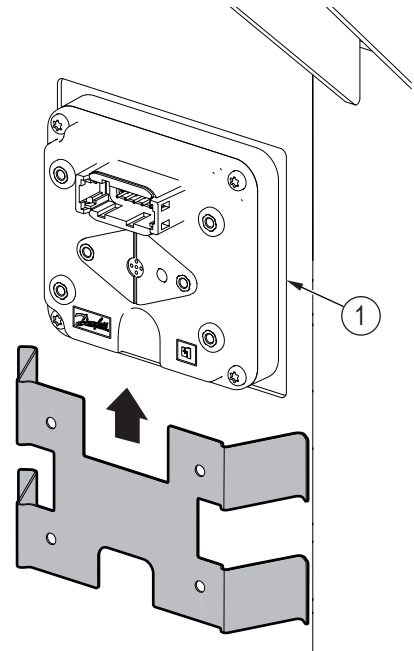

Step 8

Install the four screws (2) through the mounting bracket and into the display (1).

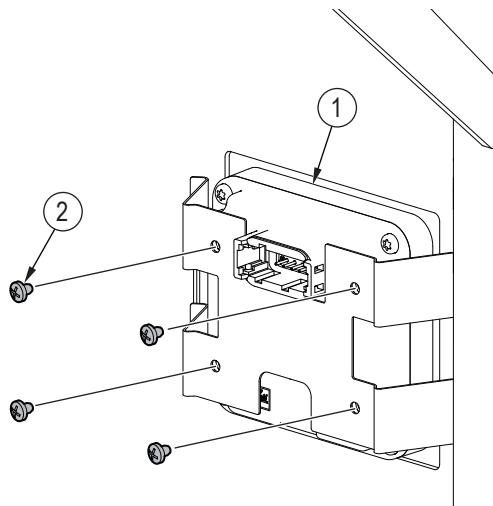

Step 9

Connect the wire harness to the display (1).

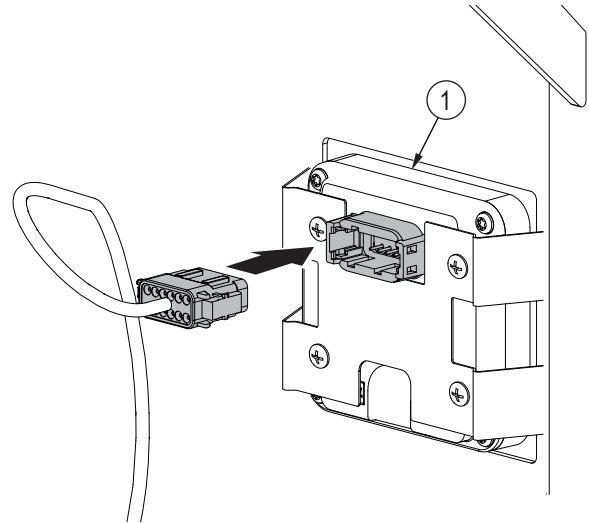

4.2 Install a P3 Pulse Display on a BXTR5224 Wood Chipper

IMPORTANT! Support the indicator panel and machine guard to prevent them from hanging on the wire harness. Components that hang on a wire harness can damage the wires and connectors.

Step 1

The P3 Pulse indicator panel is on the left side of the machine.

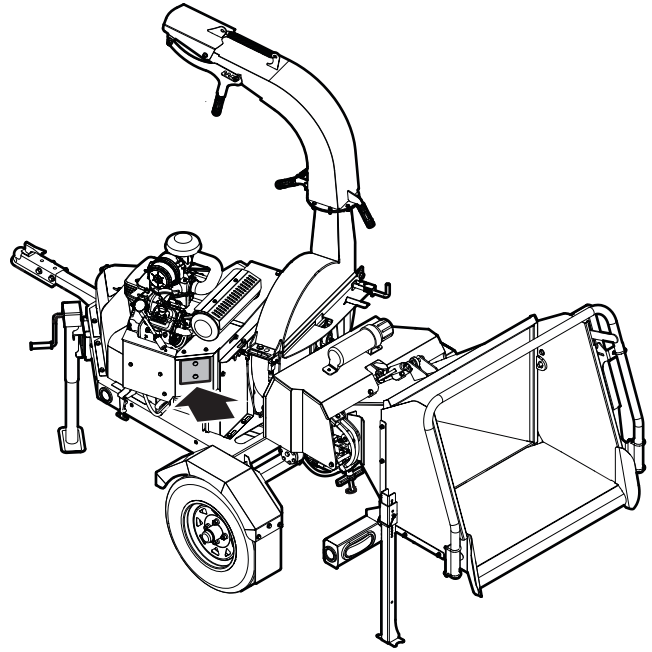

Step 2

Remove the three bolts and three washers from the machine guard that the indicator panel is installed on. Be careful with the wire harness.

Set aside the fasteners. They are necessary for installation.

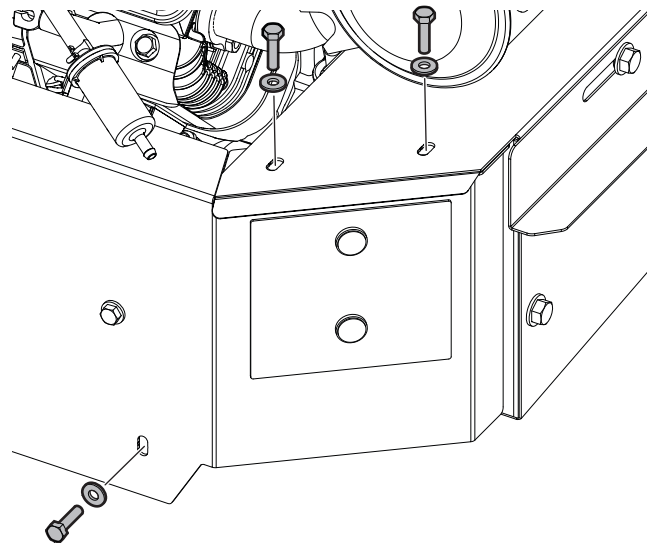

Step 3

On the rear of the indicator panel, disconnect the wire harness from the indicator panel.

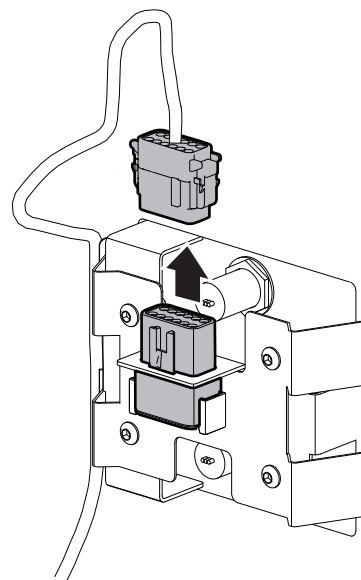

Step 4

Remove the four screws from the mounting bracket.
Set aside the fasteners. They are not necessary for installation.

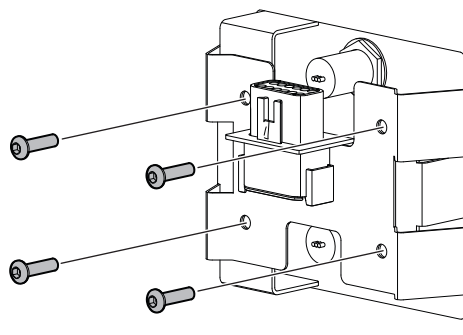

Step 5

Remove the mounting bracket.
Set aside the mounting bracket. It is necessary for installation.

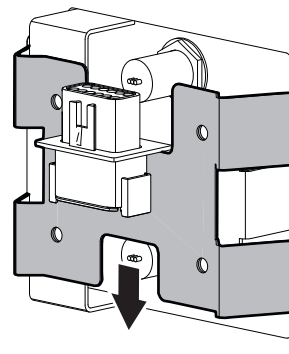

Step 6

Remove the indicator panel from the machine guard.

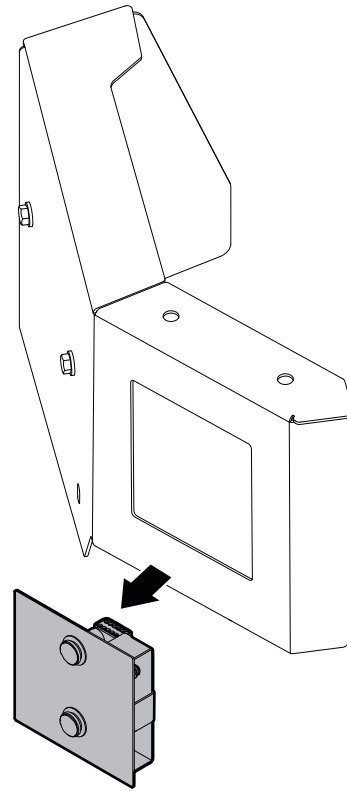
**Step 7**

Put the P3 Pulse display (1) in the machine guard.

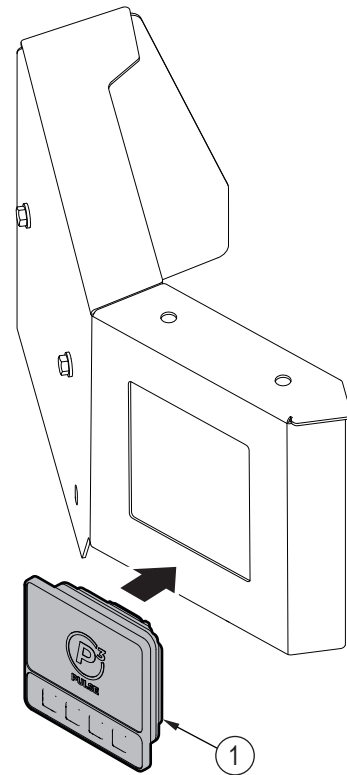

Step 8

Install the mounting bracket on the rear of the display (1).
Align the four mounting bracket holes with the display.

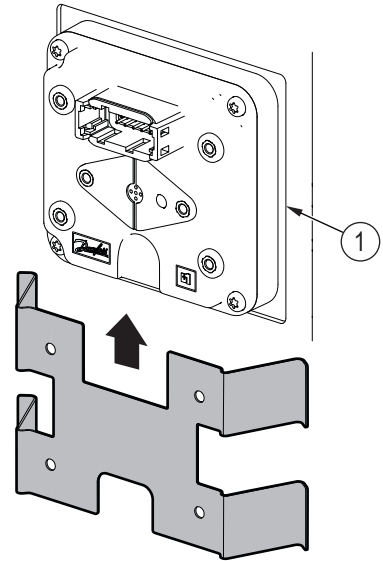
**Step 9**

Install the four screws (2) through the mounting bracket and into the display (1).

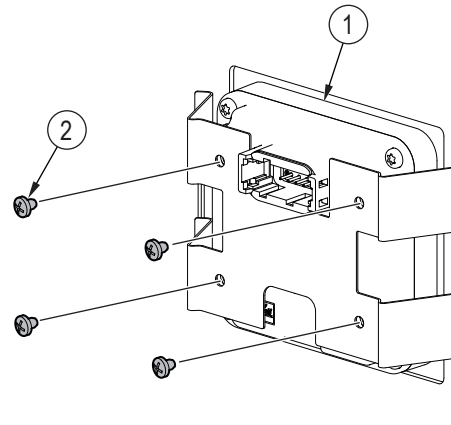
**Step 10**

Connect the wire harness to the display (1).

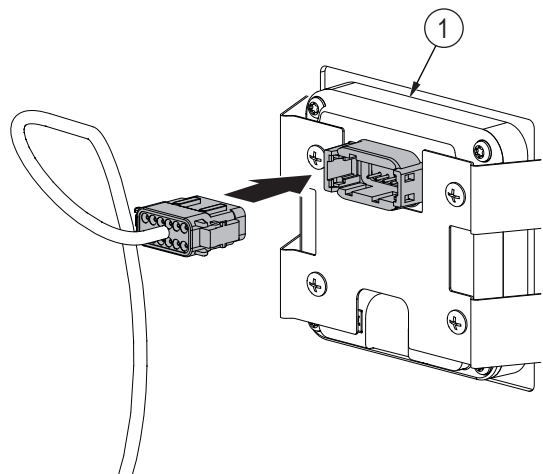

Step 11

Attach the machine guard to the machine. Install the three bolts and three washers that were removed in step 2.

Only hand tighten the fasteners.

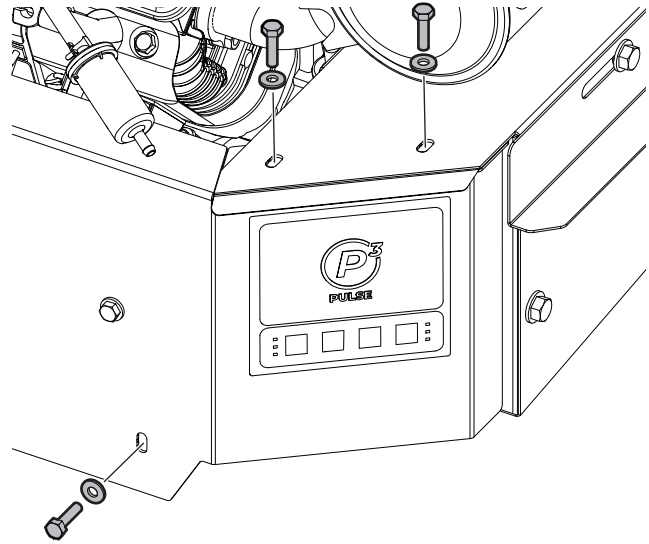

4.3 Install a P3 Pulse Display on a BXTR6438 Wood Chipper

IMPORTANT! Support the indicator panel and machine guard to prevent them from hanging on the wire harness. Components that hang on a wire harness can damage the wires and connectors.

Step 1

The P3 Pulse indicator panel is on the right side of the machine.

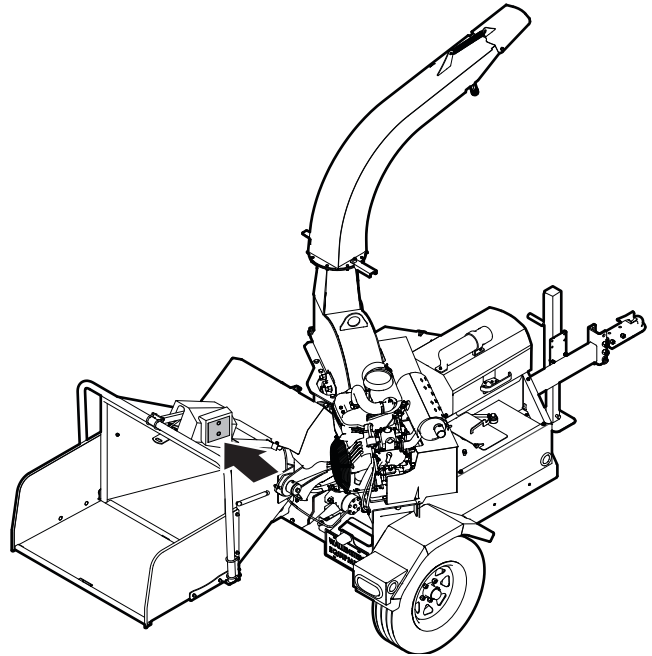

Step 2

Remove the four bolts from the machine guard that the indicator panel is installed on. Be careful with the wire harness.

Set aside the fasteners. They are necessary for installation.

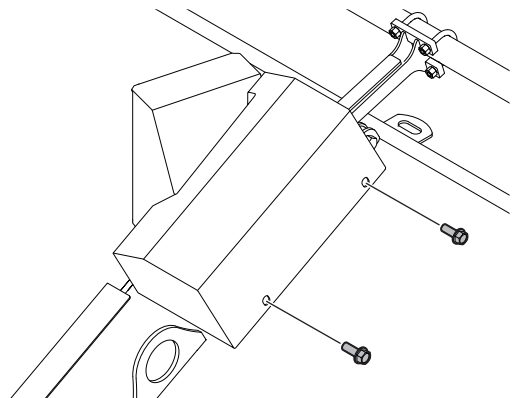
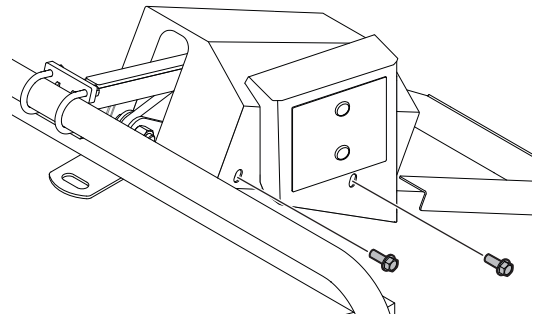

Step 3

On the rear of the indicator panel, disconnect the wire harness from the indicator panel.

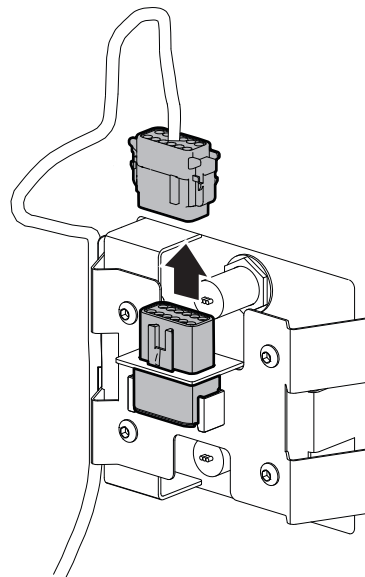
**Step 4**

Remove the four screws from the mounting bracket.
Set aside the fasteners. They are not necessary for installation.

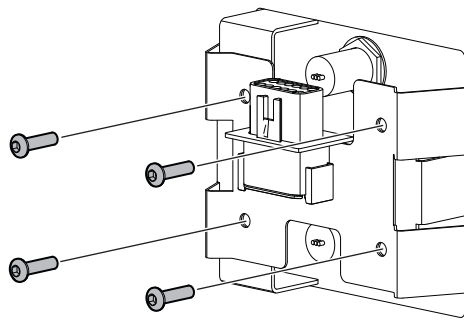
**Step 5**

Remove the mounting bracket.
Set aside the mounting bracket. It is necessary for installation.

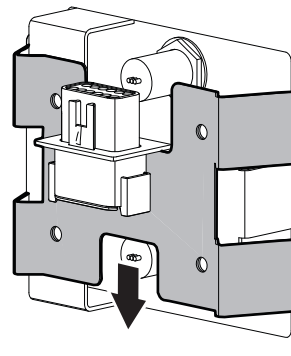

Step 6

Remove the indicator panel from the machine guard.

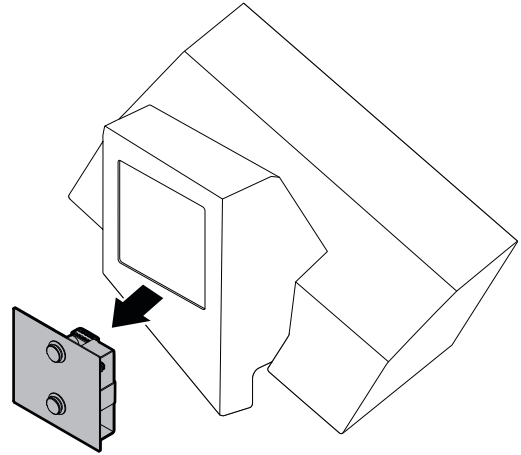
**Step 7**

Put the P3 Pulse display (1) in the machine guard.

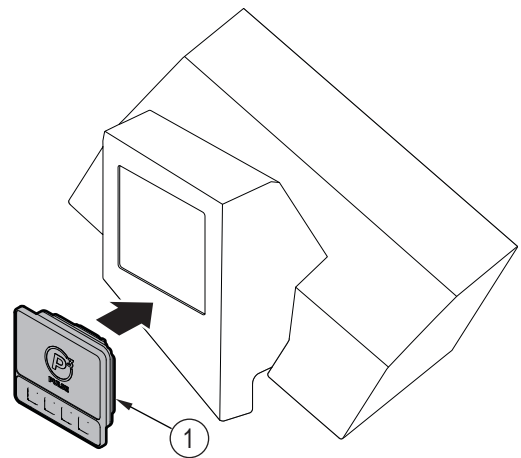
**Step 8**

Install the mounting bracket on the rear of the display (1).
Align the four mounting bracket holes with the display.

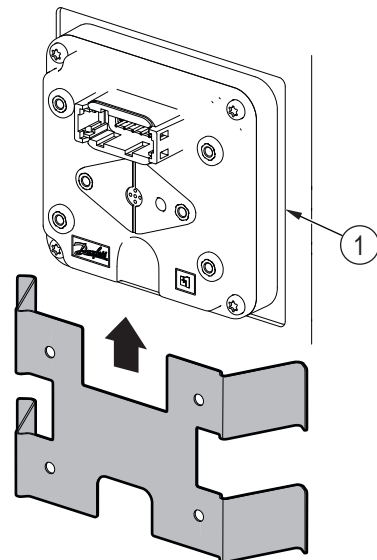

Step 9

Install the four screws (2) through the mounting bracket and into the display (1).

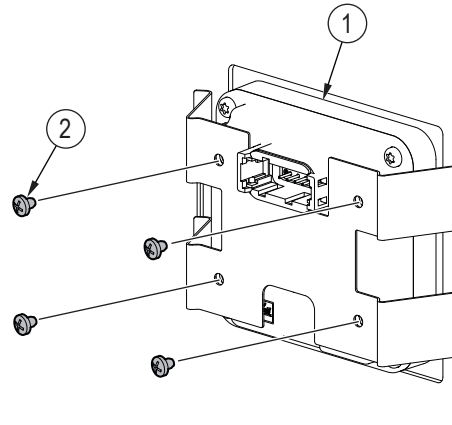
**Step 10**

Connect the wire harness to the display (1).

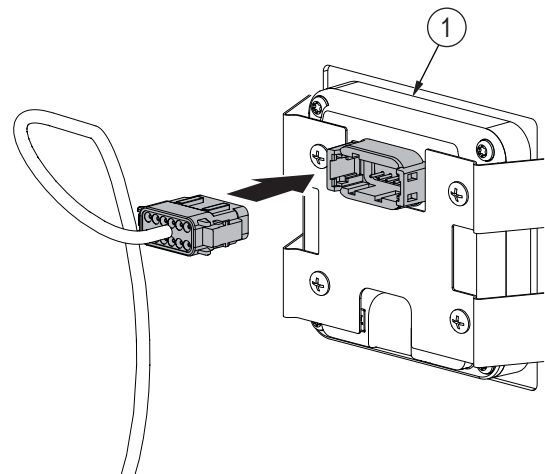
**Step 11**

Attach the machine guard to the machine. Install the four bolts removed in step 2.

Only hand tighten the fasteners.

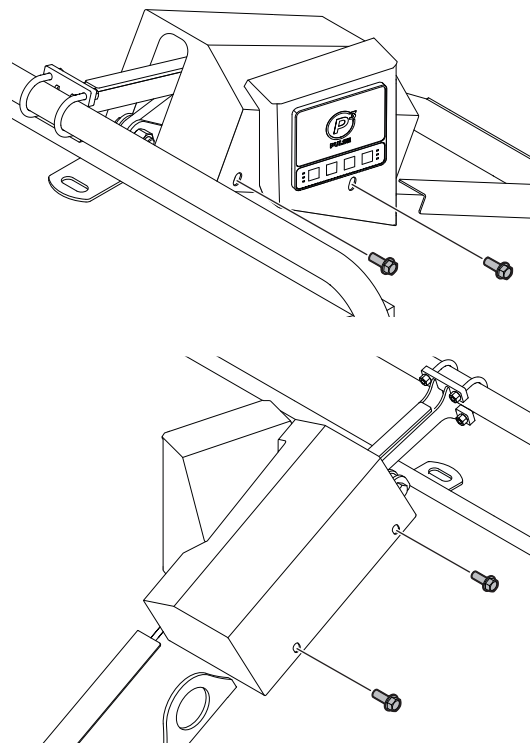

5. Test the Electrical Connection

The procedures in this section tests the P3 Pulse display electrical connection.

For more information, see the wood chipper Operator's Manual.

5.1 Test the Electrical Connection on a BX52RI, BX72RI, or BX102RI Wood Chipper

1. Turn on the tractor.
For instructions, see the tractor manual.
2. Look at the display screen.
3. Do one of the following:
 - If the display screen is on, the wire harness is connected correctly. Installation is complete.
 - If the display screen is off, do an inspection of the wire harness connection. Make sure that the wire harness connection to the tractor and the display is correct.
For more information, see the wood chipper Operator's Manual.
4. Turn off the tractor.
For instructions, see the tractor manual.

5.2 Test the Electrical Connection on a BXTR5224 or BXTR6438 Wood Chipper

1. Insert the key into the engine ignition, and then turn the switch clockwise to the **RUN** position.
2. Look at the display screen.
3. Do one of the following:
 - If the display screen is on, the wire harness is connected correctly. Installation is complete.
 - If the display screen is off, do an inspection of the wire harness connection. Make sure that the wire harness connection to the display is correct. For more help, contact your local Wallenstein Equipment dealer or distributor.
4. Turn the engine ignition switch counterclockwise to the **STOP** position, and then remove the key from the ignition.

6. Product Warranty



LIMITED WARRANTY

Wallenstein products are warranted to be free of defects in materials and workmanship under normal use and service, for a period of

Five Years for Consumer Use

Two Years for Commercial/Rental Use

from the date of purchase, when operated and maintained in accordance with the operating and maintenance instructions supplied with the unit. Warranty is limited to the repair of the product and/or replacement of parts.

This warranty is extended only to the original purchaser and is not transferable.

Repairs must be done by an authorized dealer. Products will be returned to the dealer at the customer's expense. Include the original purchase receipt with any claim.

This warranty does not cover the following:

- 1) Normal maintenance or adjustments
- 2) Normal replacement of wearable and service parts
- 3) Consequential damage, indirect damage, or loss of profits
- 4) Damages resulting from:
 - Misuse, negligence, accident, theft or fire
 - Use of improper or insufficient fuel, fluids or lubricants
 - Use of parts or aftermarket accessories other than genuine Wallenstein parts
 - Modifications, alteration, tampering or improper repair performed by parties other than an authorized dealer
 - Any device or accessories installed by parties other than an authorized dealer
- 5) Engines. Engines are covered by the manufacturer of the engine for the warranty period they specify. For the details of your engine warranty, see your engine owner's manual. Information about engine warranty and service is also available in the FAQ section at www.wallensteinequipment.com



MAKING WORK FEEL MORE LIKE PLAY™

WallensteinEquipment.com

